

BOMAT PROFITHERM UP TO 1000 kW COMBUSTION OUTPUT

Heat exchangers for flue gas heat recovery, for boilers with pressure-jet gas or oil burners (other applications on request).



▲ 06-GG-1024-NT-4-K-3

Illustration contains optional special paint and labelling

Profitherm			Product number
04-GG-1024-NT-4-K-3	up to 400 kW** combustion output	Flue gas inlet: Dint 255 Flue gas outlet: DN250 coupling	94 693 20
05-GG-1024-NT-4-K-3	up to 600 kW** combustion output	Flue gas inlet: Dint 255 Flue gas outlet: DN250 coupling	94 694 20
06-GG-1024-NT-4-K-3	up to 800 kW** combustion output	Flue gas inlet: Dint 255 Flue gas outlet: DN250 coupling	94 695 20
07-GG-1024-NT-4-K-3	up to 1000 kW** combustion output	Flue gas inlet: Dint 305 Flue gas outlet: DN315 coupling	94 696 20
08-GG-1024-NT-4-K-3	up to 1200 kW** combustion output	Flue gas inlet: Dint 305 Flue gas outlet: DN315 coupling	94 697 20

FEATURES

- Ceramic heat exchanger
- Flow switch
- Deaerator
- 3-flange* flue gas outlet in polypropylene
- Condensate drain
- Insulation
- White coated sheet steel casing
- Water connections
- 3-flange* flue gas inlet
- BOMAT safety control panel incl. 120 °C flue gas temperature limiter; AWR pump control with cable and plug

ACCESSORIES

→ see page 37

* Choice of connection options

** Design basis: 160 °C flue gas inlet temperature, 40 °C average coolant temperature, Lambda 1.2.

To optimise energy savings the water inlet temperature should be in the 30-40 °C range under operating conditions.

FOOTPRINT AND CONNECTION DIMENSIONS

04-GG-1024-NT-4-K-3 bis 08-GG-1024-NT-4-K-3 Series

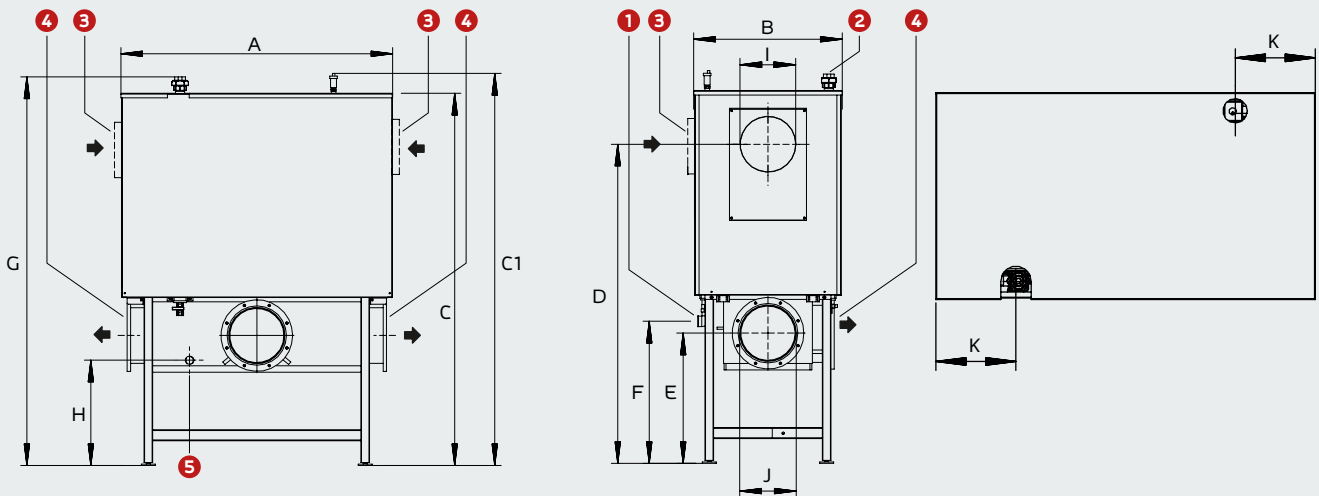

Key

- 1 Water inlet R1 ¼ EN 10226
- 2 Water outlet R1 ¼ EN 10226 with flow switch in top module
- 3 Flue gas inlet
- 4 Flue gas outlet
- 5 Condensate outlet DN50

Profitherm →		04-GG-1024-NT	05-GG-1024-NT	06-GG-1024-NT	07-GG-1024-NT	08-GG-1024-NT
Boiler size (max. combustion output)	kW	400	600	800	1000	1200
Water capacity	Liter	32,5	40,5	48,5	56,5	64,5
Flue gas HLSC, max. setting	°C	120	120	120	120	120
Permissible operating pressure	bar	3	3	3	3	3
Max. perm. flue gas inlet temp.	°C	250	250	250	250	250
Max. perm. water outlet temp.	°C	80	80	80	80	80
Max. perm. flue pressure drop	Pa	100	100	100	100	100
Weight	kg	228	262	289	327	365
Dimensions (mm)	A	1255	1255	1255	1255	1255
	B	685	685	685	685	685
	C	1730	1730	1730	1890	1890
	C1	1820	1820	1820	1970	1970
	D	1320	1400	1480	1570	1650
	E	610	610	610	610	610
	F	670	670	670	670	670
	G	1795	1795	1795	2045	2045
	H	495	495	495	440	440
	I	Di 255	Di 255	Di 255	Di 305	Di 305
	J	DN 250	DN 250	DN 250	DN 315	DN 315
	K	265	265	265	265	265

Height-adjustable +/-10 mm using adjustable feet. All data is without guarantee. Subject to change without notice.

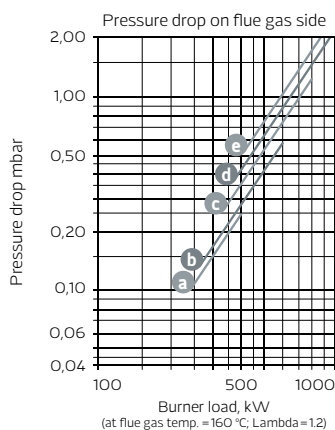
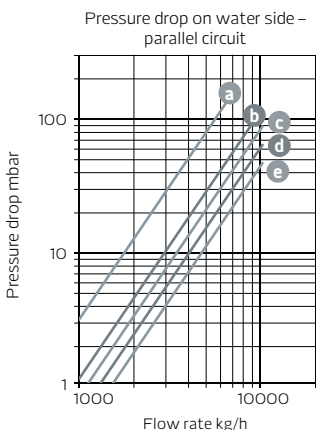

Key

- a 04-GG-1024-NT-4-K-3
- b 05-GG-1024-NT-4-K-3
- c 06-GG-1024-NT-4-K-3
- d 07-GG-1024-NT-4-K-3
- e 08-GG-1024-NT-4-K-3