

BOMAT PROFITHERM CHP INDUSTRY SERIES

Profitherm exhaust gas heat exchanger for heat recovery from CHP units.



O3-GG-1064-MT-4-9-3 ▲

▲ O1-GG-1032-MT-4-9-3

Illustration contains optional special paint and labelling

Profitherm		Product number
O1-GG-1032-MT-4-9-3	Exhaust gas inlet: DN 150 Exhaust gas outlet: DN 150	90 100 00
O2-GG-1032-MT-4-9-3	Exhaust gas inlet: DN 150 Exhaust gas outlet: DN 150	90 100 10
O3-GG-1032-MT-4-9-3	Exhaust gas inlet: DN 150 Exhaust gas outlet: DN 150	90 100 20
O1-GG-1064-MT-4-9-3	Exhaust gas inlet: DN250 Exhaust gas outlet: DN 250	90 200 00
O2-GG-1064-MT-4-9-3	Exhaust gas inlet: DN250 Exhaust gas outlet: DN 250	90 200 10
O3-GG-1064-MT-4-9-3	Exhaust gas inlet: DN250 Exhaust gas outlet: DN 250	90 200 20

FEATURES

- Exhaust gas inlet chamber made from stainless steel with cleaning cover and flange
- Exhaust gas outlet chamber made from stainless steel with cleaning cover, condensate drain connector and flange
- Modular condensing heat exchanger design with ceramic pipes
- Flow switch on coolant side
- Injection cleaning for easy manual maintenance (included)
- Mineral wool insulation and powder-coated sheet steel casing
- Max. permissible exhaust gas sound pressure level 70 dB(A); provide suitable protection on site if sound pressure is higher

ACCESSORIES

→ see page 39

FOOTPRINT AND CONNECTION DIMENSIONS

01-GG-1032-MT-4-9-3 to 03-GG-1032-MT-4-9-3, 01-GG-1064-MT-4-9-3 to 03-GG-1064-MT-4-9-3 Series

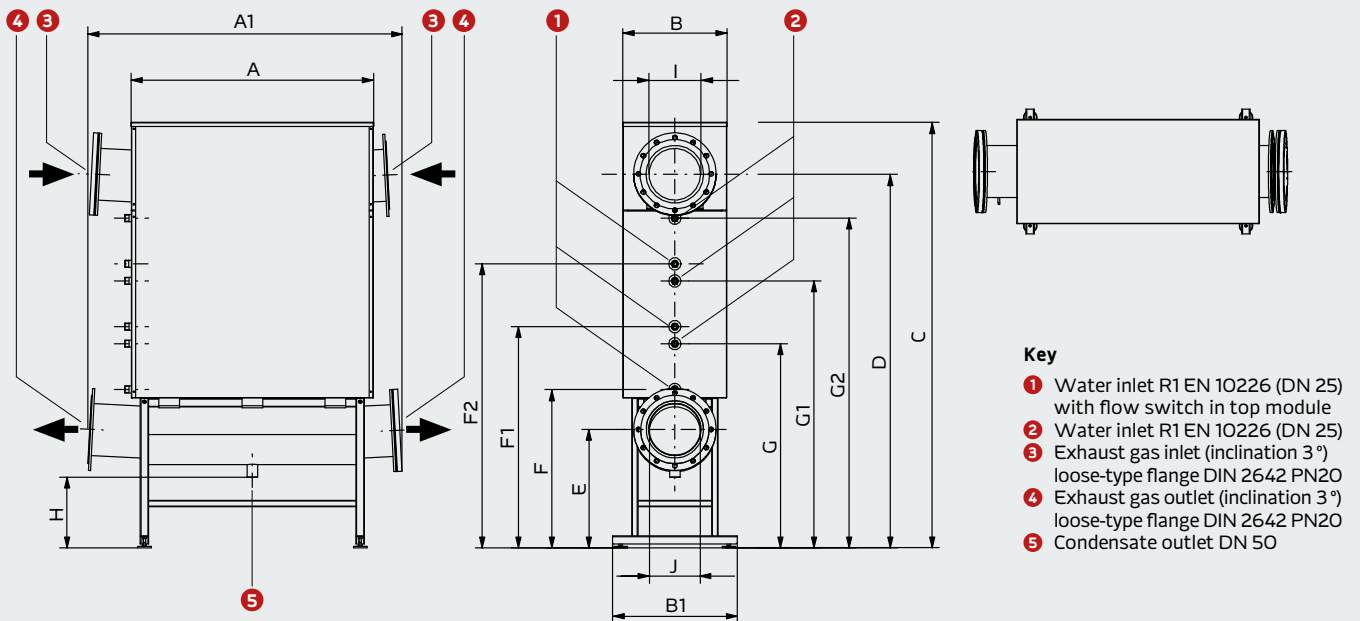

Profitherm →		01-GG-1032-MT	02-GG-1032-MT	03-GG-1032-MT	01-GG-1064-MT	02-GG-1064-MT	03-GG-1064-MT
Water capacity	litres	7,7	15,4	23,5	17,5	35,0	52,5
Exhaust gas HLSC, max. setting	°C	120	120	120	120	120	120
Permissible operating pressure	bar	3	3	3	3	3	3
Max. perm. exhaust gas inlet	°C	400	400	400	400	400	400
Max. perm. water outlet temp.	°C	80	80	80	80	80	80
Max. perm. exhaust pressure drop	Pa	5000	5000	5000	5000	5000	5000
Weight	kg	90	153	216	146	248	350
Dimensions (mm)	A	1190	1190	1190	1170	1170	1170
	A1	1410	1410	1410	1490	1490	1490
	B	288	288	288	500	500	500
	B1	600	600	600	600	600	600
	C	1270	1550	1845	1440	1740	2030
	D	1075	1375	1675	1185	1485	1785
	E	485	485	485	560	560	560
	F	660	660	660	755	755	755
	F1	x	960	960	x	1055	1055
	F2	x	x	1260	x	x	1355
	G	880	880	880	975	975	975
	G1	x	1180	1180	x	1275	1275
	G2	x	x	1480	x	x	1575
	H	330	330	330	330	330	330
	I	DN 150	DN 150	DN 150	DN 250	DN 250	DN 250
	J	DN 150	DN 150	DN 150	DN 250	DN 250	DN 250

Height-adjustable +/-10 mm using adjustable feet. All data is without guarantee. Subject to change without notice.

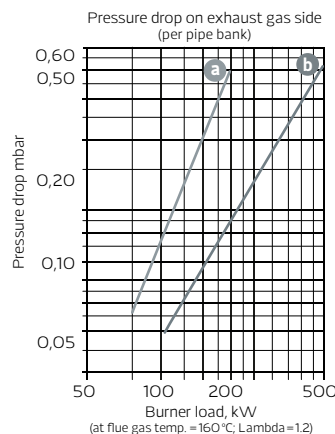
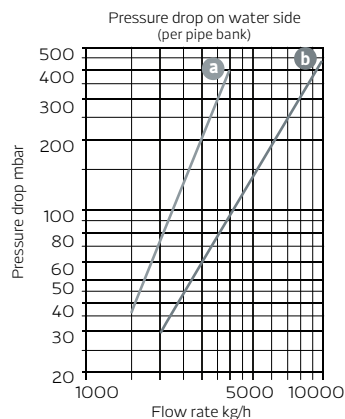

Key

- a 01-GG-1032-MT-4-9-3
- b 01-GG-1064-MT-4-9-3

BOMAT PROFITHERM CHP INDUSTRY SERIES

Profitherm exhaust gas heat exchangers for heat recovery from CHP units and industrial applications.



▲ O8-GG-1046-MT-4-9-6

Illustration contains optional special paint and labelling

Profitherm		Product number
06-GG-1046-MT-4-9-6	Exhaust gas inlet: DN 250 Exhaust gas outlet: DN 250	90 400 30
07-GG-1046-MT-4-9-6	Exhaust gas inlet: DN 250 / optional DN 350 Exhaust gas outlet: DN 250	90 400 40
08-GG-1046-MT-4-9-6	Exhaust gas inlet: DN 250 / optional DN 350 Exhaust gas outlet: DN 250	90 400 50

FEATURES

- Exhaust gas inlet chamber made from stainless steel with cleaning cover and flange
- Exhaust gas outlet chamber made from stainless steel with cleaning cover, condensate drain connector and flange
- Modular condensing heat exchanger design with ceramic pipes
- Flow switch on coolant side
- Injection cleaning for easy manual maintenance (included)
- Mineral wool insulation and powder-coated sheet steel casing
- Max. permissible exhaust gas sound pressure level 70 dB(A); provide suitable protection on site if sound pressure is higher

ACCESSORIES

→ see page 39

FOOTPRINT AND CONNECTION DIMENSIONS

06-GG-1046-MT-4-9-6 to 08-GG-1046-MT-4-9-6 Series

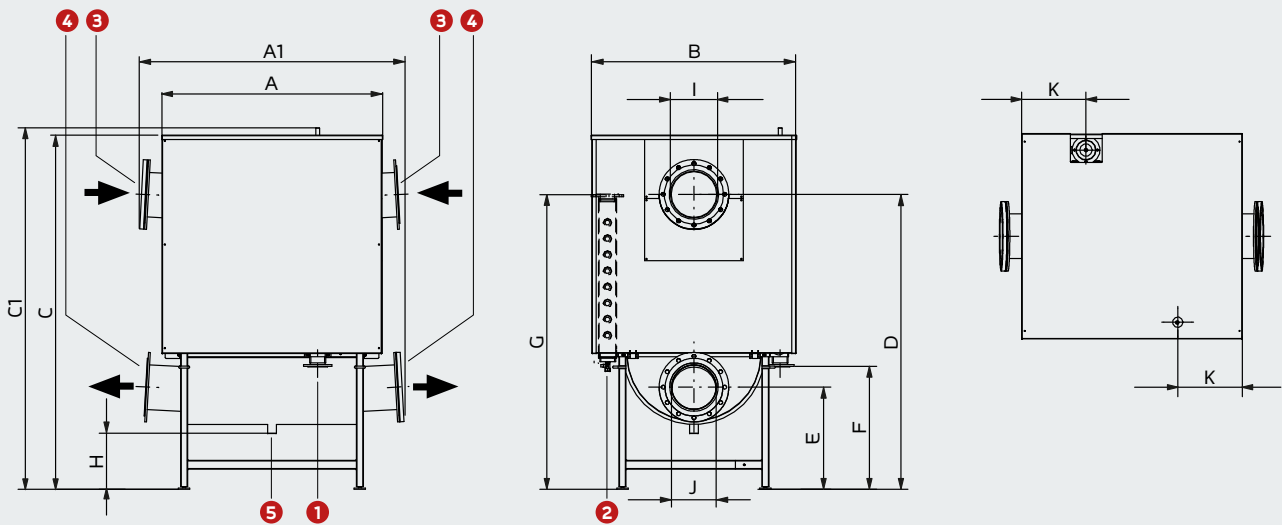

Key

- 1** Water inlet DN 65
- 2** Water outlet DN 65 with flow switch in top module
- 3** Exhaust gas inlet (inclination 3°) loose-type flange DIN 2642 PN20
- 4** Exhaust gas outlet (inclination 3°) loose-type flange DIN 2642 PN20
- 5** Condensate outlet Da 50

Profitherm →		06-GG-1046-MT	07-GG-1046-MT	08-GG-1046-MT
Water capacity	Liter	98	112	127
Exhaust gas HLSC, max. setting	°C	120	120	120
Permissible operating pressure, heating water side	bar	6	6	6
Max. perm. exhaust gas inlet temp.	°C	400	400	400
Max. perm. water outlet temp.	°C	80	80	80
Max. perm. exhaust pressure drop	Pa	5000	5000	5000
Weight	kg	700	750	800
Dimensions (mm)	A	1255	1255	1255
	A1	1475	1475	1475
	B	1170	1170	1170
	C	2030	2030	2030
	C1	2075	2075	2075
	D	1535	1615	1695
	E	600	600	600
	F	715	715	715
	G	1555	1555	1555
	H	335	335	335
	I	DN 250	DN 250	DN 250
J	DN 250	DN 250	DN 250	
K	370	370	370	

Height-adjustable +/-10 mm using adjustable feet. All data is without guarantee. Subject to change without notice.

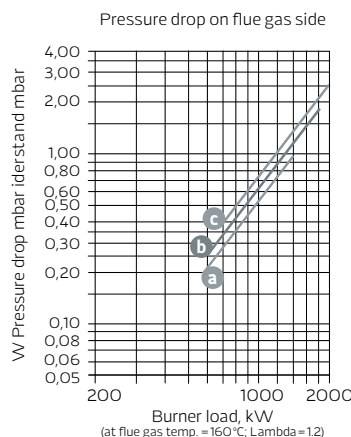
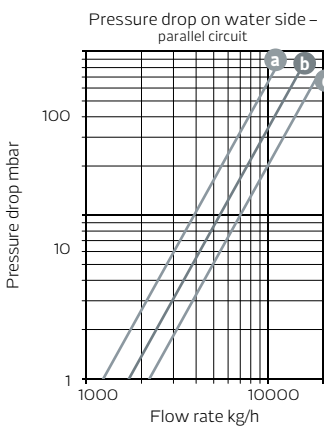

Key

- a** 06-GG-1046-MT-4-9-6
- b** 07-GG-1046-MT-4-9-6
- c** 08-GG-1046-MT-4-9-6